



CORPORATE
COMPANY
PROFILE



**WE DELIVER
THE AGREED QUALITY
EVERY TIME**



INDEX

- Profile Details
- About Us
- Our Director Board
- Vision, Mission , Value
- Quality Control & Assurance
- Product & Brands
- Compliance Audit
- Production Informations
- Services & Facilities
- Machinery in Plant & List of Machinery
- Our Freight Forwarders, Testin Labs,
Curier Service Providers.
- Workplace Environment
- Location & Important
- Factory Layout
- Contact





PROFILE DETAILS

Company Registered Name	SBMH Company Limited
Year of Establishment	2023
Company Type	100% Myanmar Investment
Oversea Office	-
Product Type	Jacket/Pants/Blouses/Skirts/Vest
Market	Europe/Japan/Korea
Factory Area	Land Area - 8041 Sqm Production Area - 7041.25 Sqm
Sale System	CMPT
Employee	1000
Number of Lines	10
Capacity Per Month	80000 - 120000 Pcs (Jackets) 120000 - 180000Pcs (Pants) 180000 - 280000Pcs (Blouses)
Correspondent information	No.267, Zaykabar 6 th Street, Yangon Industrial Zone, Yangon. Tel : +959 824 666 35, 9777 9 333 71
Contact Person	U Zaw Linn Latt Daw Wai Mar Lwin

ABOUT US!

SBMH is a dynamic garment company established in 2023, committed to delivering high-quality, stylish, and sustainable fashion. With a focus on modern trends and exceptional craftsmanship, we cater to a diverse clientele, offering a range of clothing that combines comfort, elegance, and durability. Our mission is to redefine fashion standards by embracing innovation, ethical sourcing, and environmental responsibility. Since our inception, we have been dedicated to not only providing excellent products but also fostering long-term relationships with our customers, suppliers, and community.

BOARD OF DIRECTORS



Mr Zaw Linn Latt
Managing Director



Mrs Thu Zar Han
Executive Director



Mr Myo Chit San
Director

STRATEGY

VISION

Our Vision is to serve our customers with Dedication and offer Specialized Services with Quality Assurance, We are Quality Driven Organization and Content to render quality services and products to our clients, Our Team of Manufacturing Process to ensure that the products are flawless.

MISSION

We are the Company That Manufactures apparel products of high quality for the societies of the world that wish to enhance their living standard.

OUR VALUE

Quality : We deliver the agreed Quality Every time.

Relations : Our Success is Base on good relations with all our Customers and Colleagues. We Believe that Expectations and that understanding is a prerequisite for real value creations.

Focus : We keep the focus on creating value for our Customers and for the group as a whole.

Solutions : Continues engineering to provide solutions for our Customers.

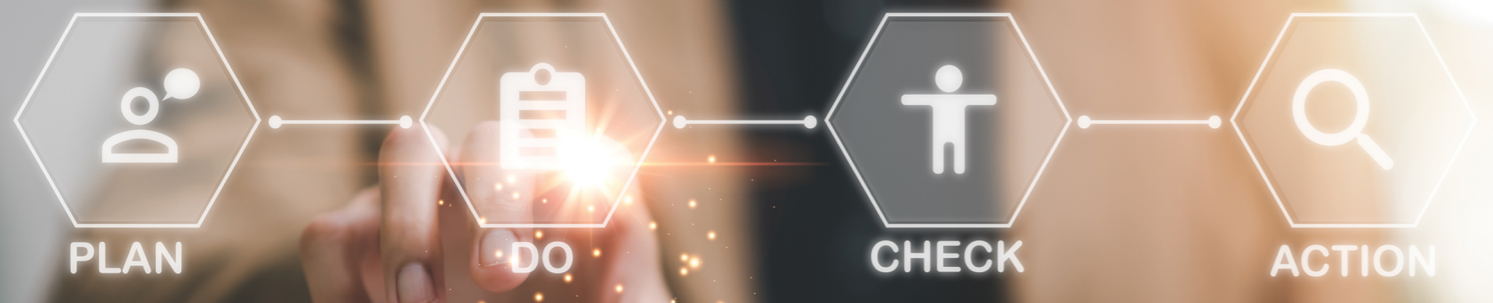

PRODUCTS & BRANDS

QUALITY CONTROL & ASSURANCE



Through out its short period of operation, SBMH Garment has perfected its Quality Control System, which includes scrupulous checks, to ensure flawless production. the experienced Quality Assurance (QA) team extends its operation even into the procurement of raw-materials and machinery, SBMH, has continuously restructured this system, it has acquired the latest Quality Control equipment, and developed quality consciousness among the workforce, Due to its firm grip on quality regulations, SBMH Garment can meet the best AQL requirements of clients.

At SMBH Barment, client satisfaction is company satisfaction.



REWARD NKD	Feltics
 TEDDY BEAR SLOGAN HERE	▶ DeFacto
JF CLOTHING	joma™
NEWYORKER	NnF Now N Forever
indicode	GIVERNY



PRODUCTS PRO
BRANDS BRANDS



We make the Quality **PRODUCTS**

WINTER WEARS



We make the Quality **PRODUCTS**

WINTER WEARS & Polo Shirt



We make the Quality
PRODUCTS

PANTS, SKIRTS & BLOUSES

We make the Quality
PRODUCTS

PANTS & SKIRTS



We make the Quality
PRODUCTS

JACKET



We make the Quality
PRODUCTS

SKIRTS & BLOUSES



A U D I T



COMPLIANCE AUDIT

Empowering responsible supply chains



WORKPLACE ENVIRONMENT

As a Responsible apparel producer, SBMH Garment provides employees a work environment high above the law-required level. SBMH, installed and has updated lighting, ventilation and ergonomics of its plants using latest technologies. The goal is to exceed requirements of local legislation and reach the global standards, and there by support clients' images and sourcing principles. Clearly demarcated emergency routes & exits, smoke & fire detectors, consciously designed working lay-outs ensure a safe workplace for workers. As per Audit requirements, instructions and warning signs are posted in highly visible places.

Moreover, usage of metal gloves in times of fabric cutting, needle guard in time of sewing and such similar procedures reduces significantly work-related accidents. Besides being safe, SBMH Company Limited, workplace offers a congenial & supporting environment for all managerial staffs and workers work in mutual cooperation and respect.



WAREHOUSE DEPARTMENT



CUTTING DEPARTMENT



FABRIC STORE WITH RAW MATERIAL



ITEM	QTY	STATUS	BACK	BACK NAME
1				
2				
3				
4				
5				
6				

FABRIC CUTTING



FABRIC SPREADING



FABRIC INSPECTION



SEWING DEPARTMENT



QUALITY DEPARTMENT



AUTOMATIC TEMPLATE SEWING DEPARTMENT

We have a well Equipped Production unit, which is backed by Hi-Tech Machines and state of the art technology. Our Infrastructure is backed by excellence manufacturing and processing facility that help us strengthen our quality standards and ensure on-time delivery.



CAD DEPARTMENT



Plotter Machine

Computer Template Cutter Machine

Computer-aided design and marker

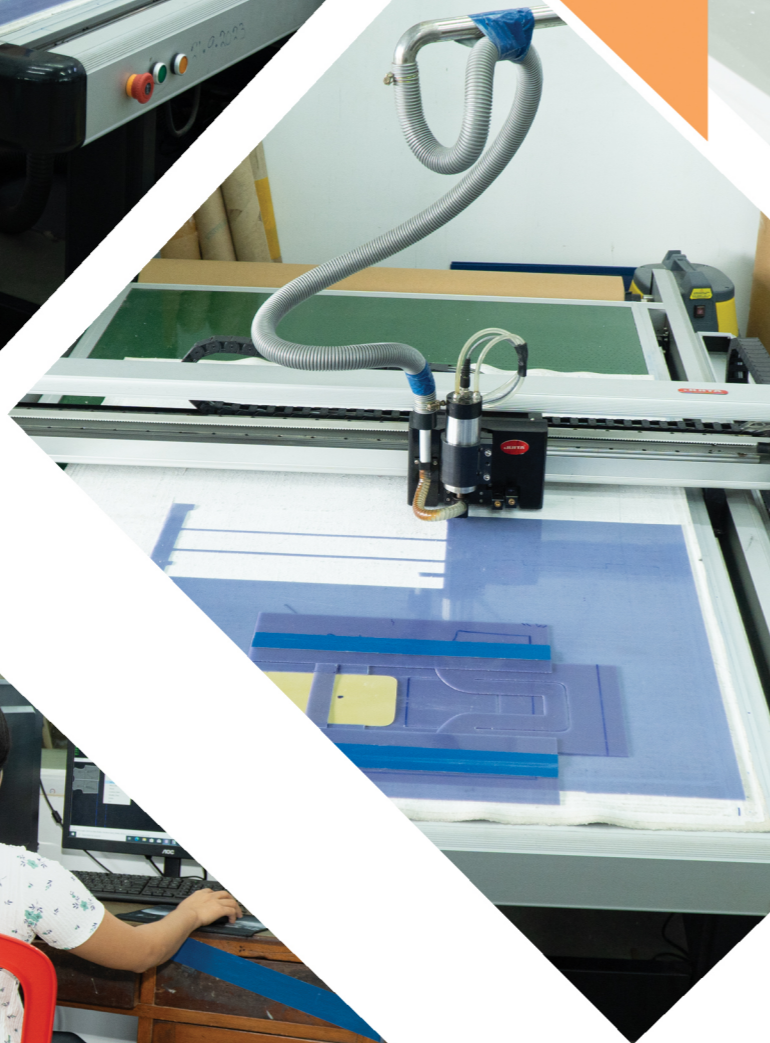

SAMPLE DEPARTMENT

Abality

Flexibility

On Time Delivery

Competitive Price

Product Safety





FINISHING DEPARTMENT

HUMIDITY CONTROL ROOM



FINISHED CARTON STORAGE AREA



POLY BAG / PACKAGING



TYPES OF MACHINE

- Single Needle Machine
- Two Needle Machine
- Overlocking Machine
- King Machine
- Kansai Machine
- QQ Machine
- WK Machine
- Bar-tacking Machine
- Button-attaching Machine
- Button hole Machine
- Key hole Machine
- Manual Long-armed Machine
- Auto Long-armed Machine
- Snapping Machine
- Fabric Inspection Machine
- Fabric Relaxing Machine
- Piping Machine
- Fusing Machine



MACHINERY IN PLANT



JUKI

brother®

JACK

ZOJE

PEGASUS®

KANSAI
SPECIAL_{LO}

BOK

JUITA®

HIKARI

ZHONGGONG

HASHIMA

iSEW®



OUR FREIGHT FORWARDERS

eUSU: Logistics



OUR COURIER SERVICE PROVIDER



GOOGLE MAP FOR IMPORTANT PLACE



1	Near Bus Stop		1.8 Km	10 Min
2	Fire Station		5.8 Km	30 Min
3	Hospital		2.5 Km	16 Min
4	Police Station		3 Km	18 Min
5	Airport		3.6 Km	23 Min
6	High Way Station		1.8 Km	10 Min

SEWING LINE LAYOUT PLAN

THANK YOU

www.sbmh.mm.com

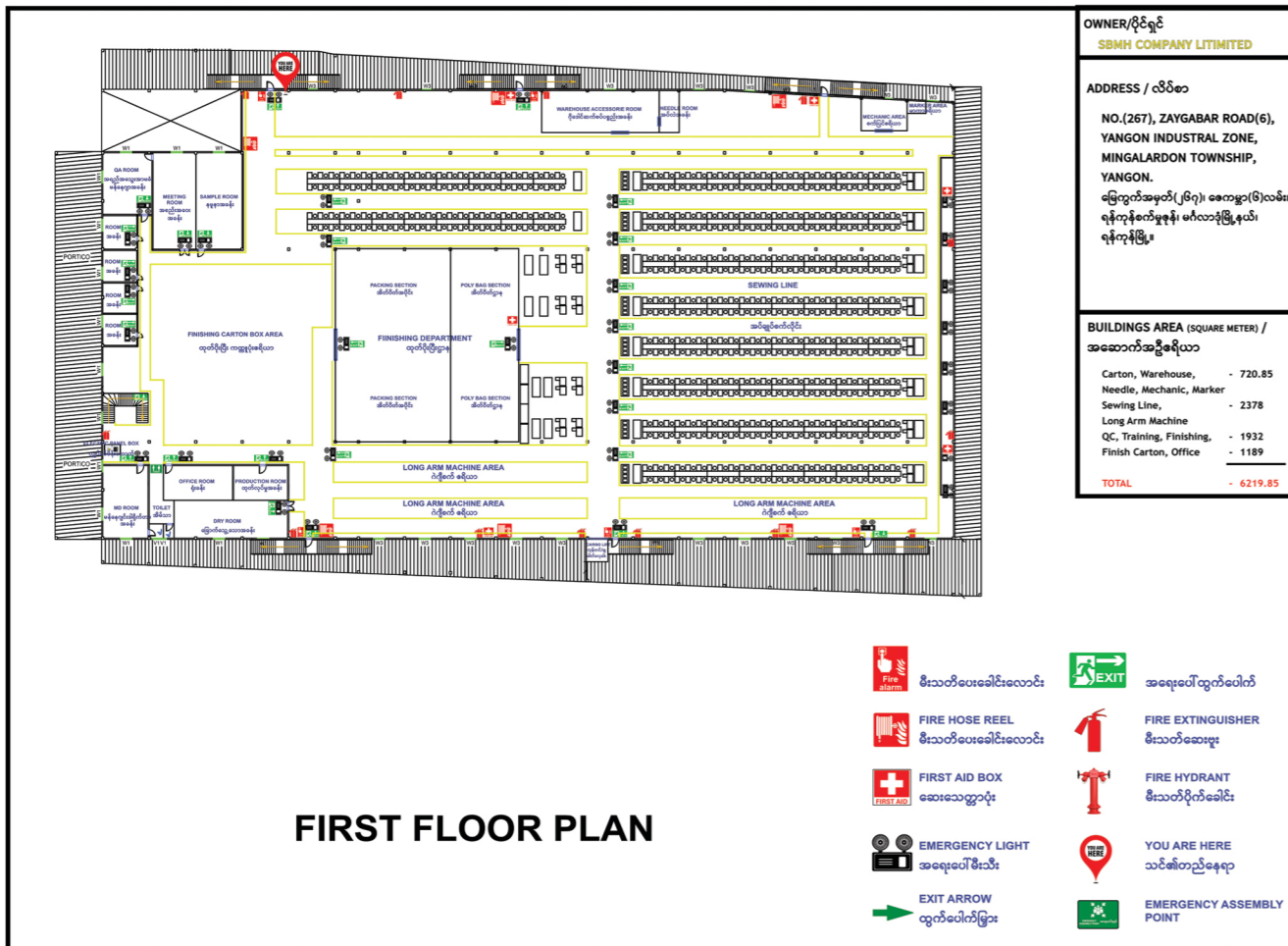
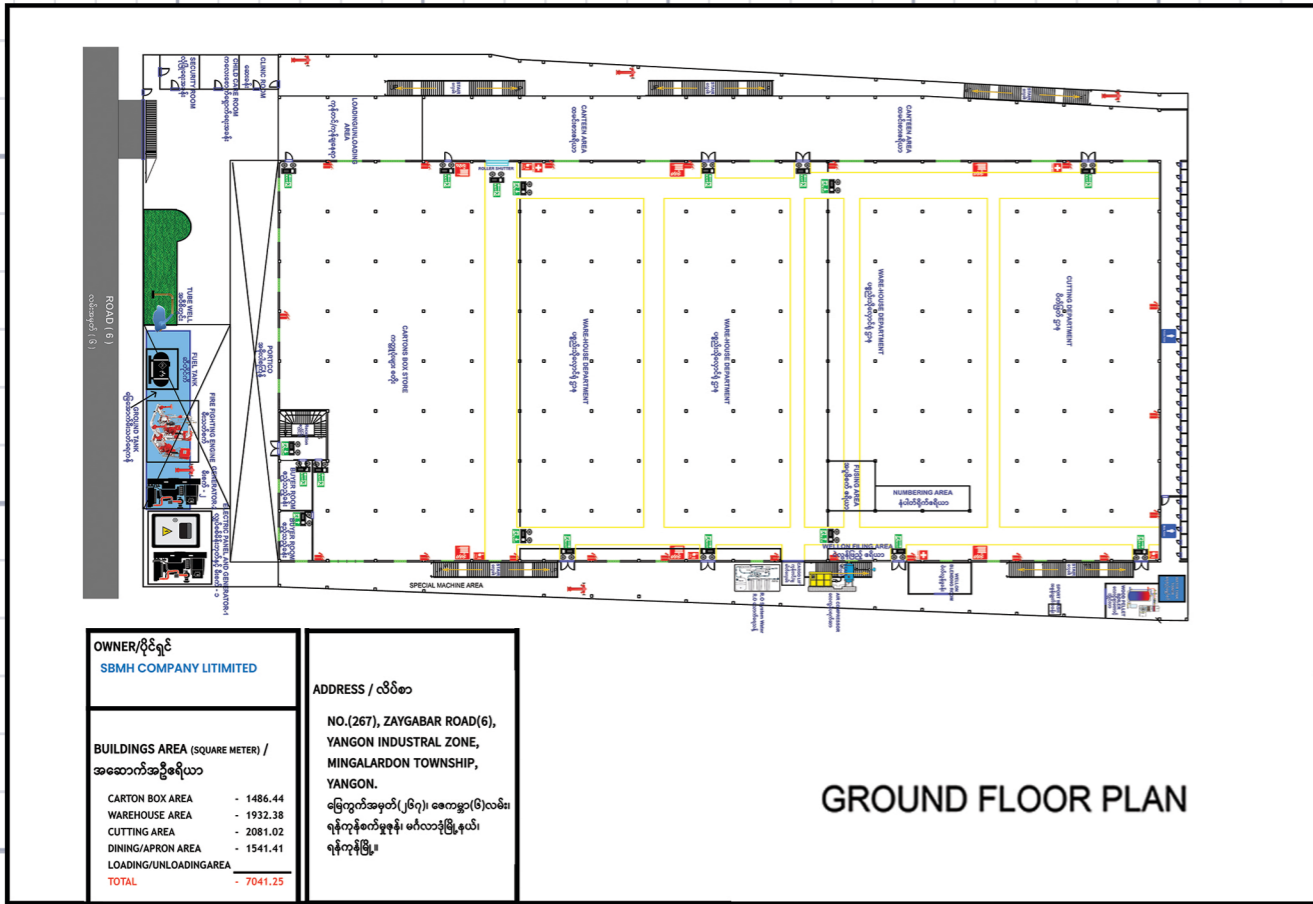

Thanks You! for Visiting **SBMH Company Limited** Our Inquiries and Comments are Greatly Welcomed and will be Responded to in a Timely Manner.



SBMH Company Limited

📍 No. 267, Zaygabar 6th Street, Yangon Industrial Zone,
Mingalardon Township, Yangon, Myanmar.

☎ (+95) 9 824 666 35 , 9 777 9 333 71

✉ kphmyanmar@gmail.com, kphsingapore@gmail.com